

The ITF heavy duty extruded aluminium curtain track is suitable for use in schools, theatres, and many other commercial applications.

The track is designed to cater for large and/or heavy drapes.

It can be fitted directly to overhead soffit fixings, or secured by a variety of available track hanging brackets.

Features

- Anodised black matt finish
- Wide variety of accessories
- Easily curved
- No welding required
- Light weight (1.62 kg/m)
- Can be fixed at 2.0-2.5 m centres

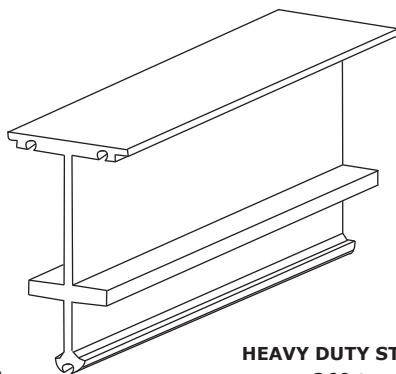

HEAVY DUTY STAGE TRACK
360 track hd

TECHNICAL DATA

Weight : 1.578 kg/m
Material : Aluminium
Finish : Black anodised
Standard length: 6 mts

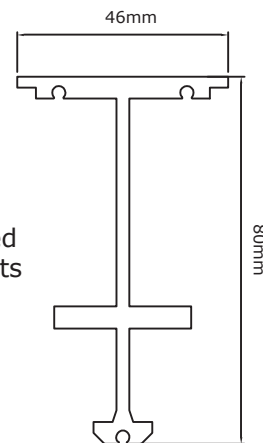

TRACK SECTION

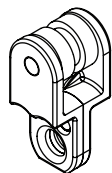

RUNNER
362 runner

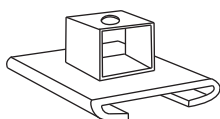

HANGING BRACKET BLOCK
363 hbracket block

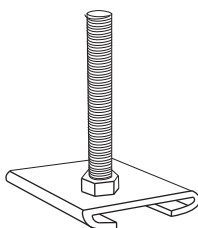

HANGING BRACKET M10
363 hbracket thr

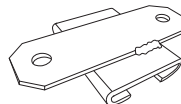

HANGING BRACKET-CEILING FIX
363 hbracket topfix



HOOK CLAMP -M10 hole
363 hclamp-m10

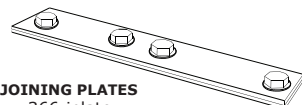

JOINING PLATES
366 jplate
(Includes 3 joining pins)

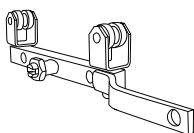

MASTER CARRIER-cranked
365 crledr

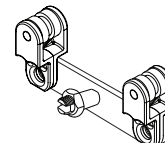

MASTER CARRIER-straight
365 stledr

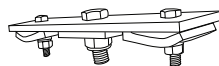

TRACK SPACER CLAMP
368 trk cl



LIVE PULLEY
367 lv puly

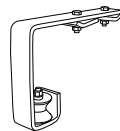

DEAD PULLEY
367 dd puly

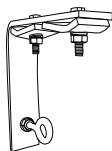

ROPE GUIDE
364 pickup lb

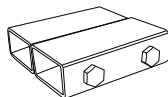

SINGLE PULLEY PACKER
368 trk pkr



WEIGHTED FLOOR PULLEY
367 w8t puly

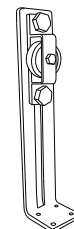

**ADJUSTABLE PULLEY
FLOOR MOUNTED**
367 ajs puly



**90 DEGREE TRACK BEND
800mm RADIUS**
360 hd 8b

**90 DEGREE TRACK BEND
600mm RADIUS**
360 hd 6b

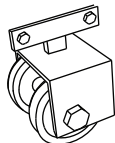

END PULLEY-DOUBLE
367 dbl puly

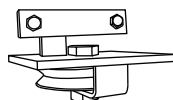

END PULLEY-SINGLE
367 sgl puly

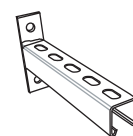

WALL BRACKET - 250mm
304 WB 250

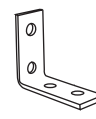

**L-BRACKET
100mm x 110mm**
304 LB 100